



Zeeba Hills Subdivision



*Hartford,
Wisconsin*



Zeeba Hills is *the* last subdivision within walking distance of Hartford's schools, parks, and downtown shops and restaurants.



Zeeba Hills offers a small-town feel allowing you to live comfortably in peace and privacy.



So relish the hilltop view, take a peaceful walk around the neighborhood, and enjoy a game of golf before sunset...

It's all here at *Zeeba Hills*

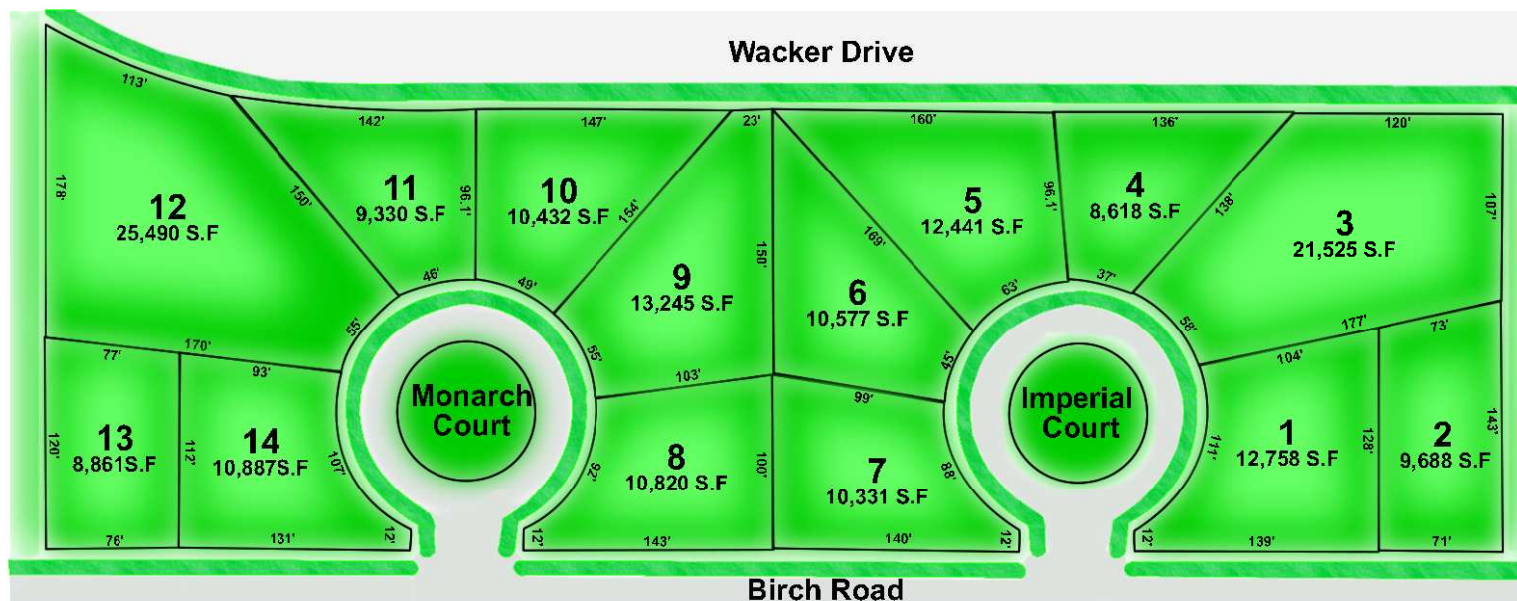

For lot information contact:

Chris Berkel

RE/MAX Town & Country

384 W. Sumner Street
Hartford, WI 53027

262-673-6900 Ext. 11

www.ZeebaHills.com



- Prices from \$53,900 to \$69,700
- Municipal water, sewer, curb & gutter
- Underground utilities
- Bring your own builder!

Front & Side Yard Setbacks

- 20 feet street side
- 25 feet back yard
- 10 feet side yard

Square Footage Requirements

- *Ranch* – 1400 square feet
- *Two story* – 1700 square feet
- *Multi level* – 1400 square feet

Roof Pitch Minimum

- 8/12 Ranch
- 6/12 Two & Multi Story
- 4/12 Porch

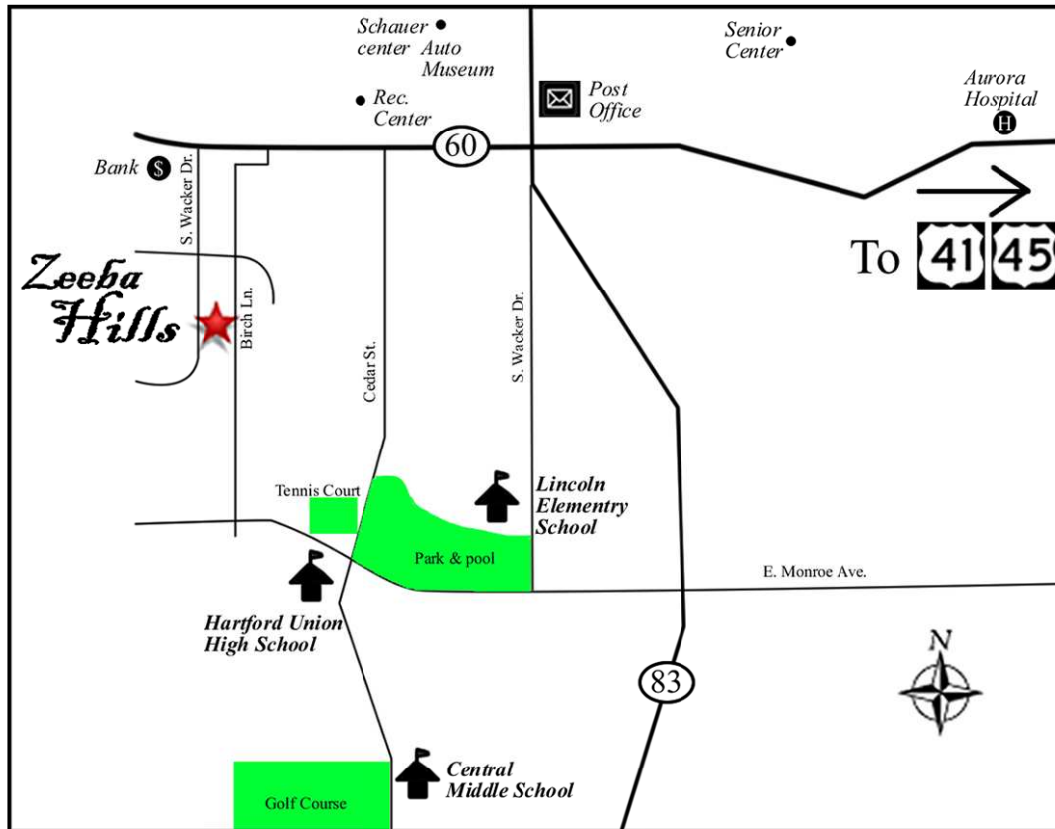

262-673-6900 Ext. 11
www.ZeebaHills.com



KARBASSI DEV
 Karbassi Development
 Expect a Higher Standard